

# Topic: Access walkways & Maintenance platforms



Supplied by : SYNERGY CORPORATION

Manufactured by: DAEO PRECISION IND CO LTD

# Best-in-class in comfort & security



- **High slip resistance:** Carefully designed surface ensure that the line proves end-users with maximum slip resistance.
- **Suitable for high altitudes:** The DAEO Footing is very suitable to be used at high altitudes. Due to its light weight construction.
- **Optimal strength to weight ratio:** The sturdy design of the DAEO Footing ensures a construction that is as light as its strong. Lighter than a mesh grating with the same strength.
- **Install with a breeze:** DAEO Footing has been designed to be simple and easy to install. This allows for quicker installation in challenging environments, allowing safety for end-users on short notice.
- **Flexible by design:** DAEO Footing can be used in various types of Power plant, environments, industries, and applications. The product line is available in various widths, heights, lengths, and profile forms and can furthermore be customised to meet your exact needs.
- **NO Tools required for Installation of footings**

# Side view of platform insertion



**SYNERGY**  
CORPORATION

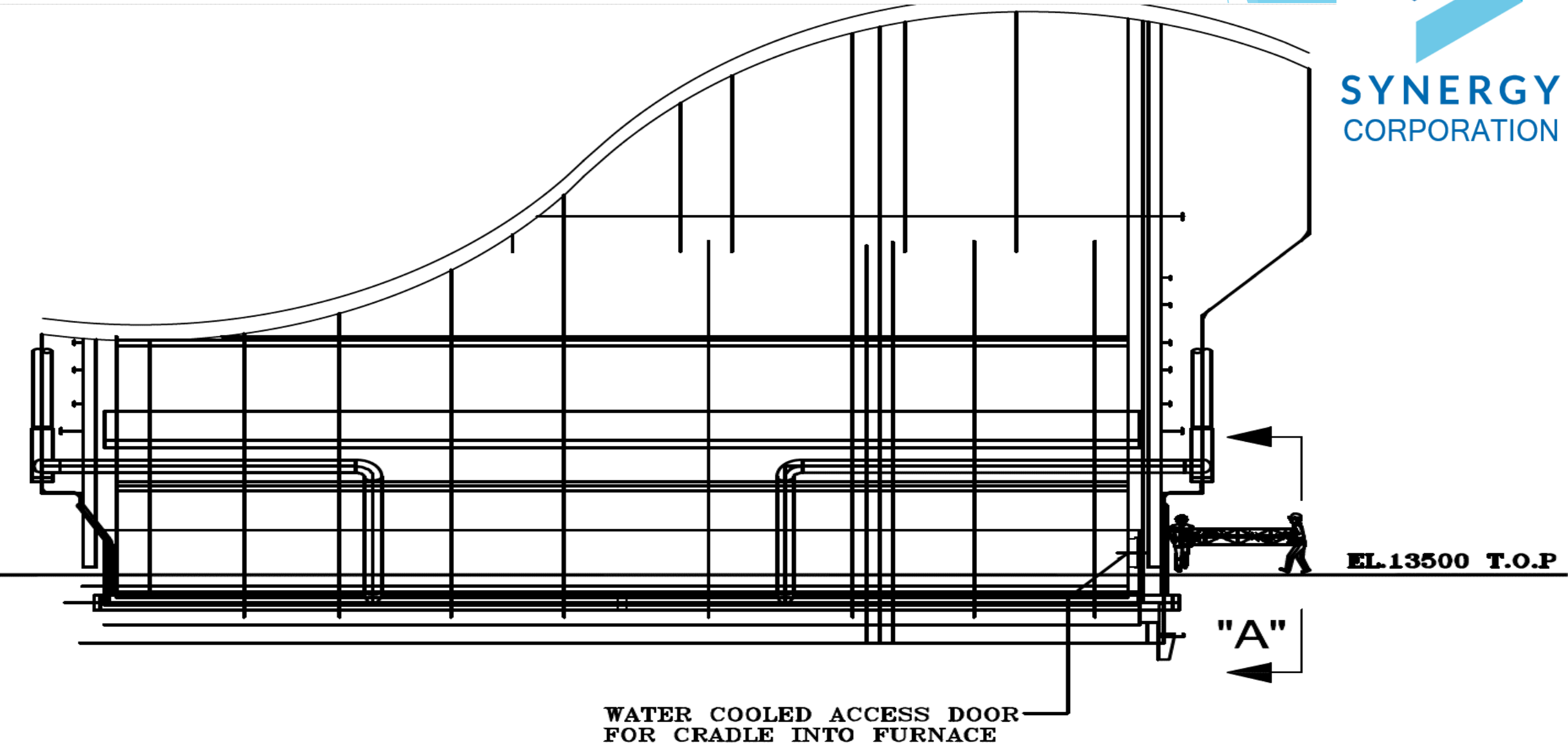

**EL.13500 T.O.P**

**"A"**

**WATER COOLED ACCESS DOOR  
FOR CRADLE INTO FURNACE**

# Placement of Platform inside furnace floor



SYNERGY CORPORATION

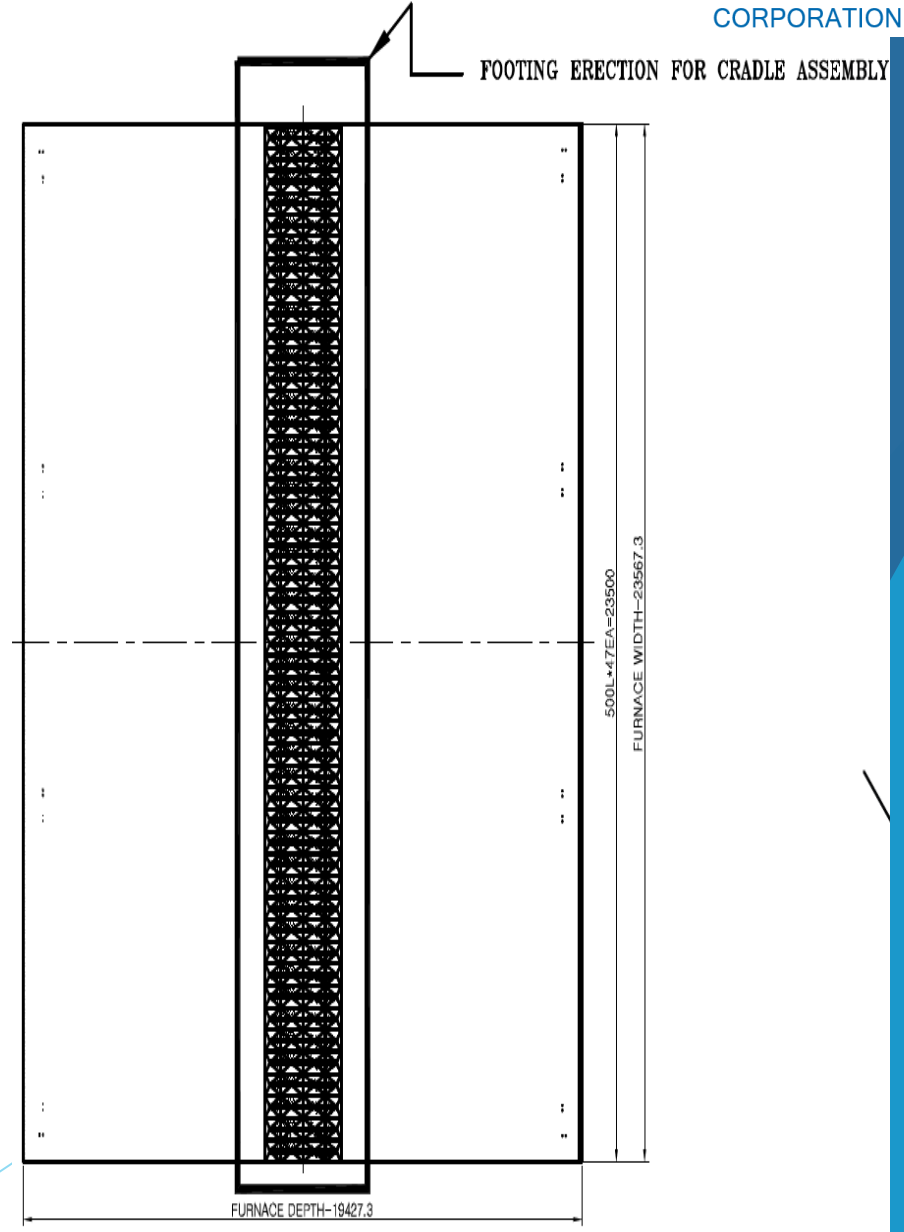
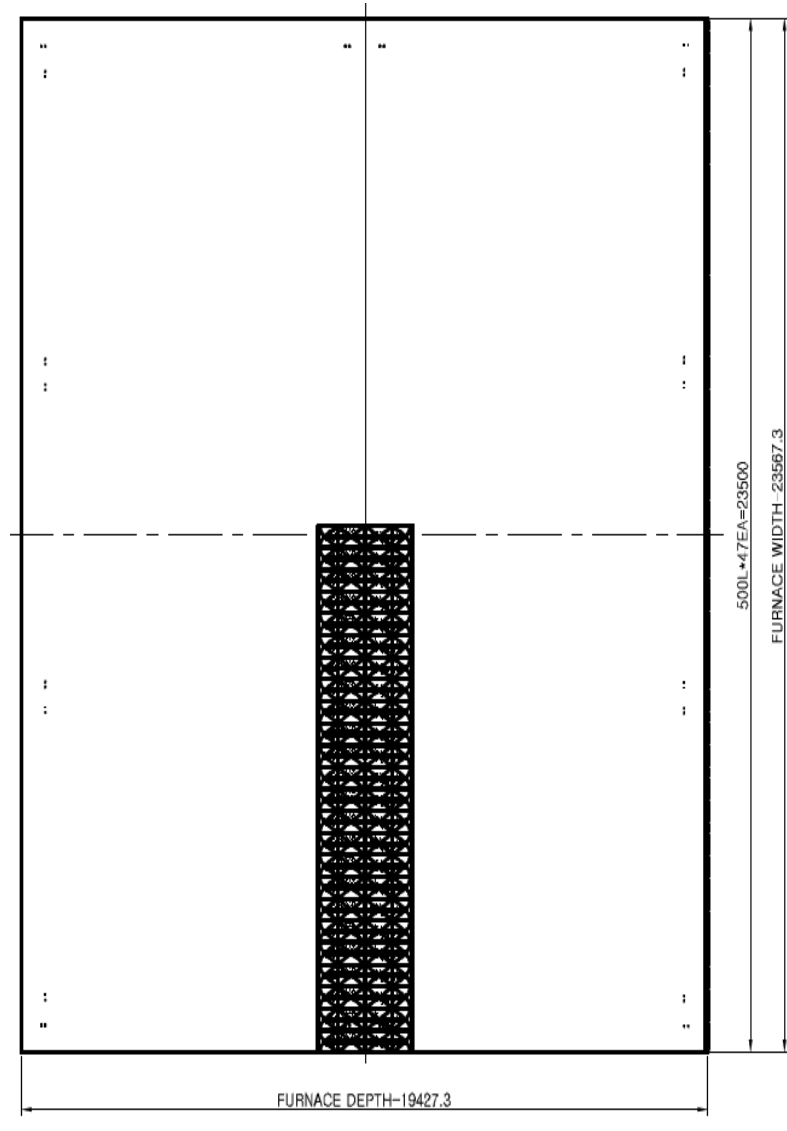
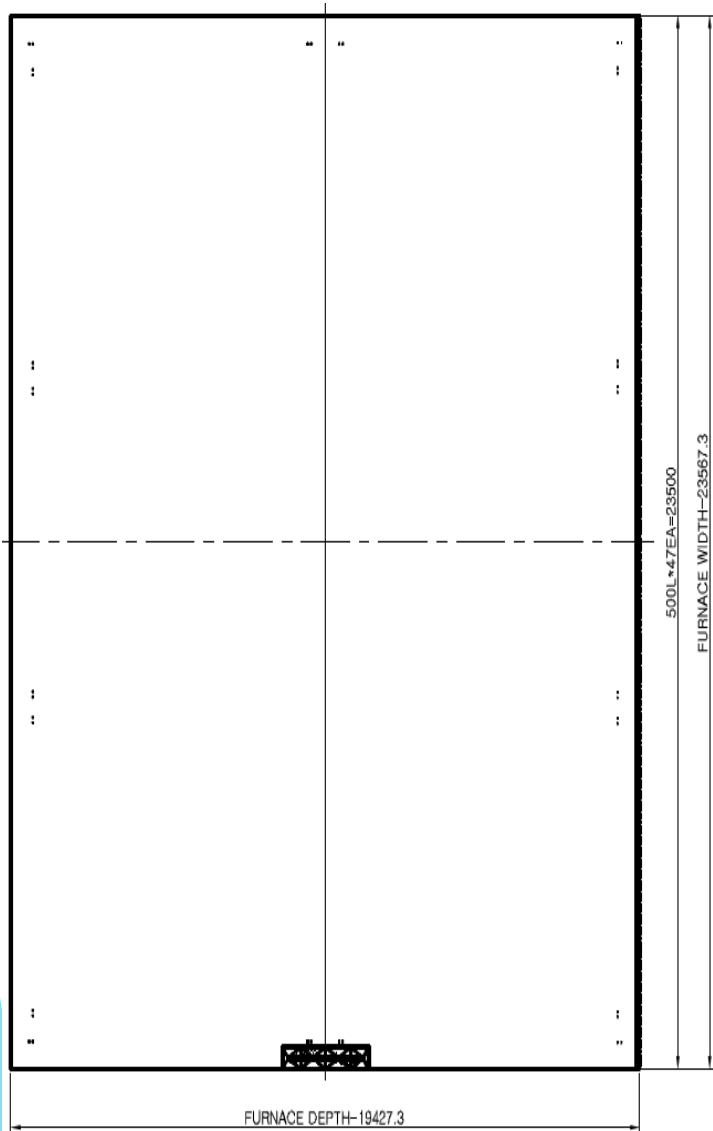

# Post installation view



**SYNERGY**  
CORPORATION

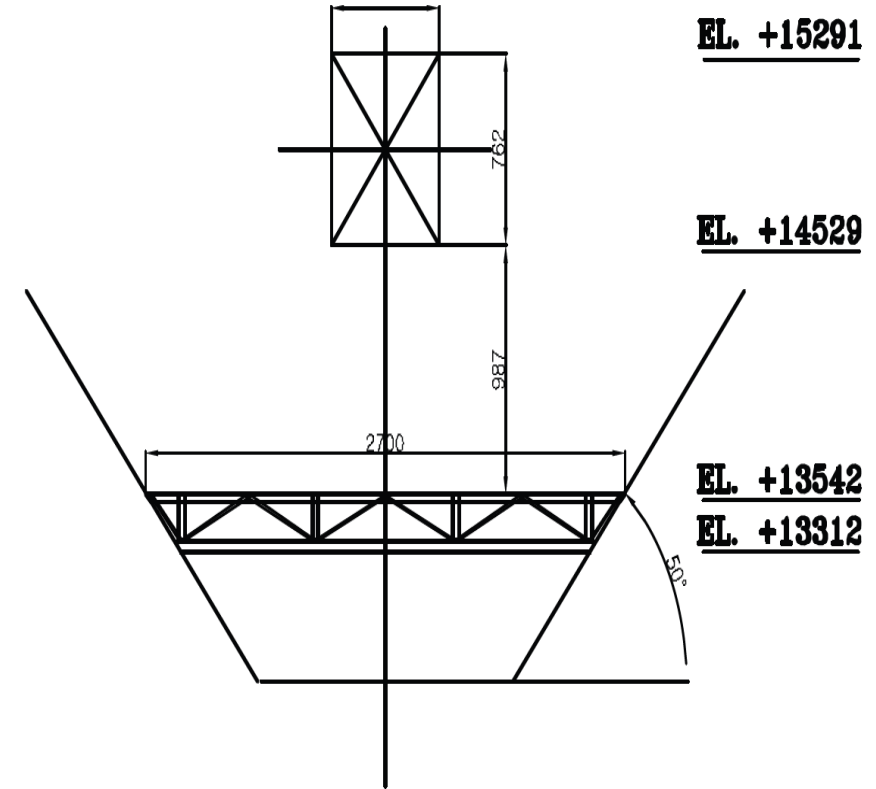
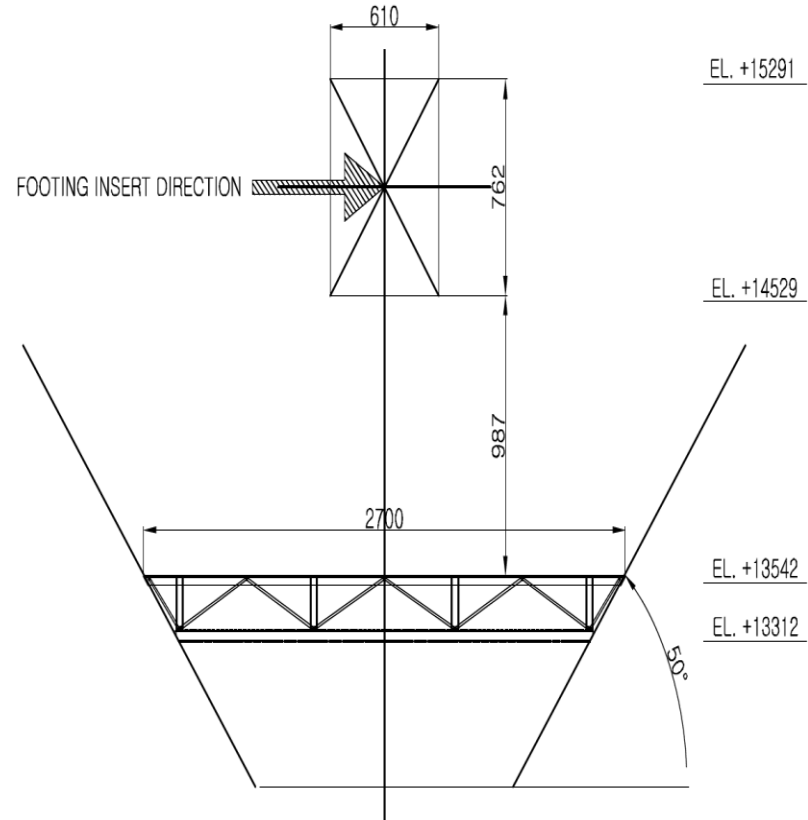
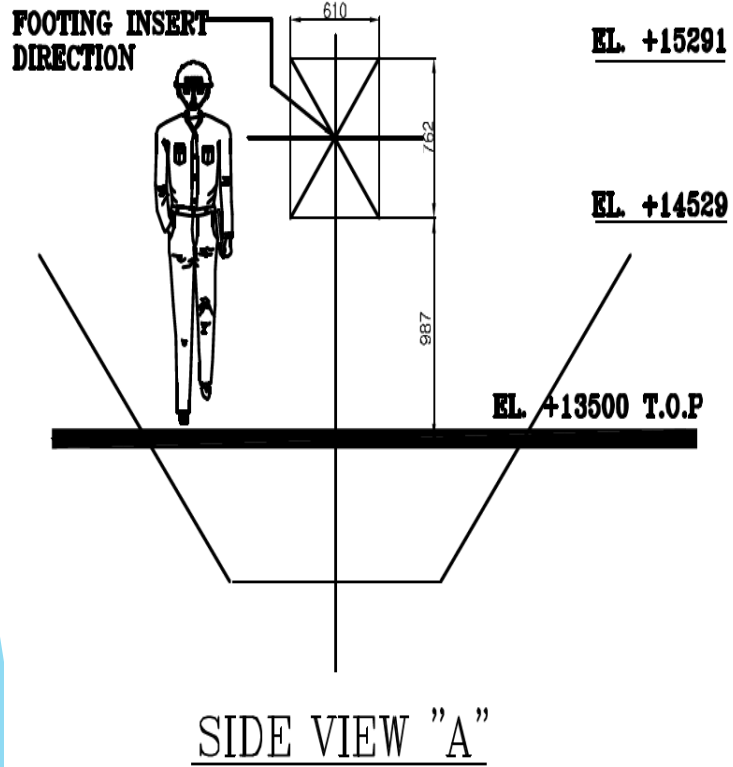

# TECHNICAL SPECIFICATION/MOC /DESIGN



**SYNERGY**  
CORPORATION



# Engineering Safety



Safety is present in all aspects of what we do:

Safety is at the very heart of our products, solutions and through everything we do. Our drive is to enable our customers - no matter your industry - to safely operate in their business environment, supported and surrounded by innovative DAEO solutions.

DAEO is dedicated to help professionals engineer safety into every project and strive to follow our brand promise. Our products and solutions are used in many different types of buildings, applications, and installations. They are often exposed to harsh influences in heavy cargo, chemicals, high frequency cleaning, and weather and wind.

Therefore, our products must live up to a high level of safety. The advice we offer about the dimensioning, use and maintenance of the products ensures our customers the optimal and safe solution for their particular project.

# OUR WORLD PRESENCE



SYNERGY  
CORPORATION

## DAEO FOOTINGS



Created with [www.ipmaps.com](http://www.ipmaps.com)



# OUR CLIENTS



**SYNERGY**  
CORPORATION

| SR NO | PLANT NAME                            | CAPACITY | COUNTRY      |
|-------|---------------------------------------|----------|--------------|
| 1     | NTPC LARA                             | 1600 MW  | INDIA        |
| 2     | NTPC KUDGI                            | 2400 MW  | INDIA        |
| 3     | SHUQAIQ STEAM POWER PLANT             | 2640 MW  | SAUDI ARABIA |
| 4     | RABIGH COMBINED CYCLE POWER PLANT     | 2060     | SAUDI ARABIA |
| 5     | YANBU 3 DUAL-FUEL POWERED POWER PLANT | 3300     | SAUDI ARABIA |
| 6     | MARAFIQ YANBU GAS TURBINE POWER PLANT | 517      | SAUDI ARABIA |
| 7     | DANGJIN COAL-FIRED POWER PLANT        | 2400 MW  | SOUTH KOREA  |
| 8     | HONAM COAL FIRED POWER PLANT          | 500 MW   | SOUTH KOREA  |
| 9     | GHECO-ONE POWER PLANT                 | 660 MW   | THAILAND     |



**SYNERGY**  
CORPORATION

**THANK YOU FOR JOINING US**